

D GB

VIGOUR

Technische Informationen
Technical information



white Duschtassen
white Shower Trays

Montageanleitung
Instruction manual

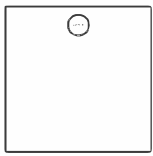

90x90

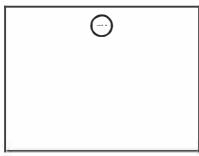

120x90

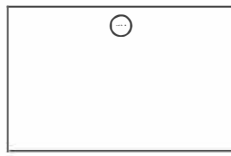

140x90

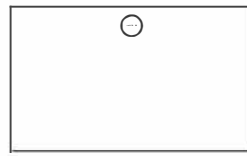

150x90

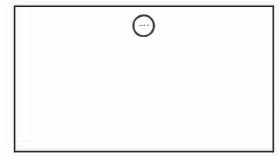

160x90

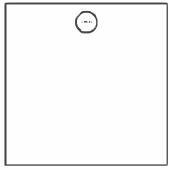

100x100

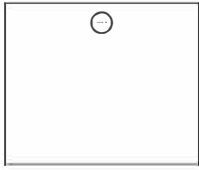

120x100

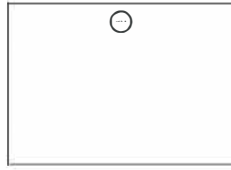

140x100

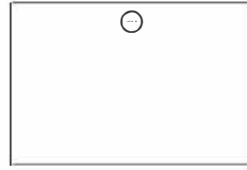

150x100

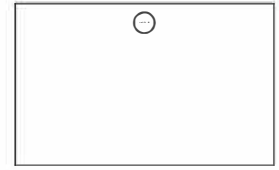

160x100

Im Lieferumfang enthalten
Included on delivery



Viega Tempoplex Bauhöhe 60mm
zu verwenden (nicht enthalten)
Viega Tempoplex to use, height
60mm (not included)

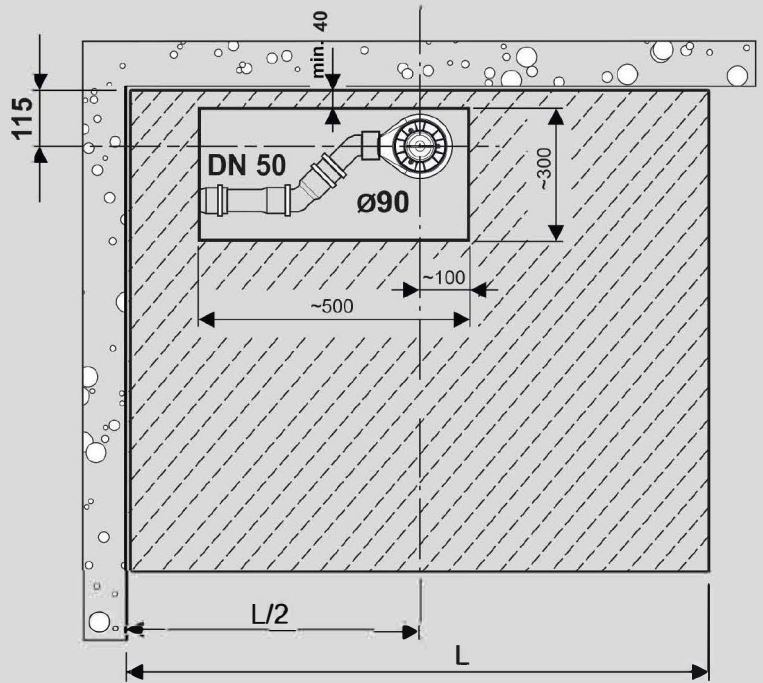
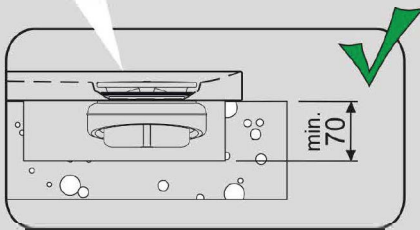
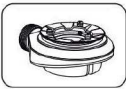

1

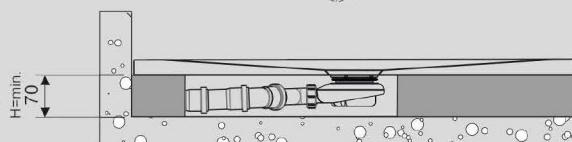
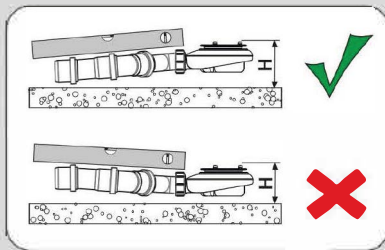

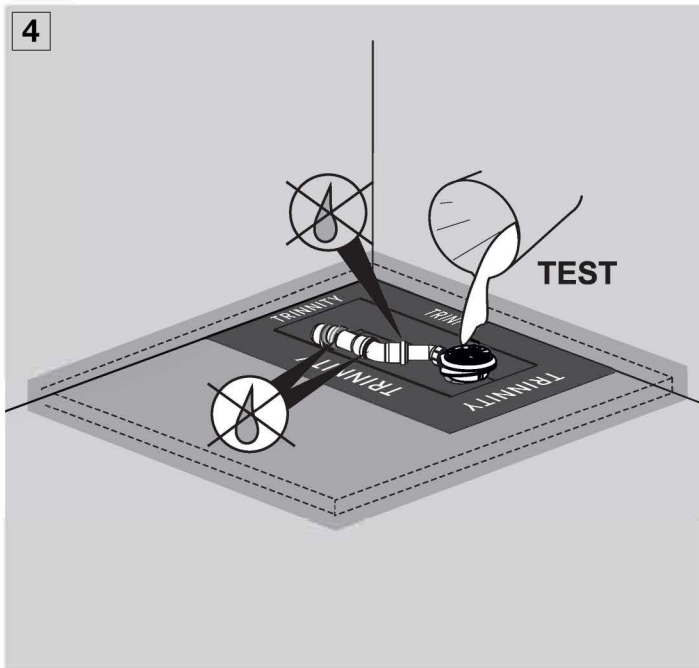
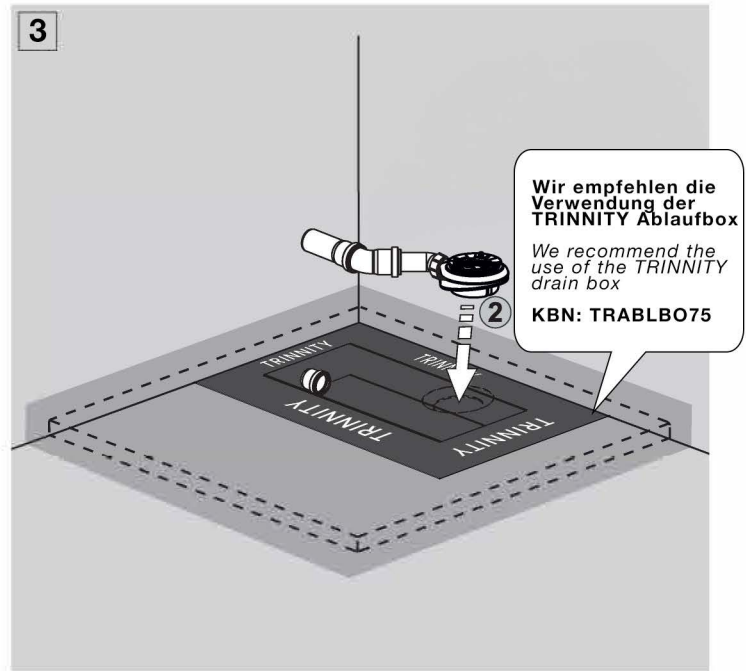
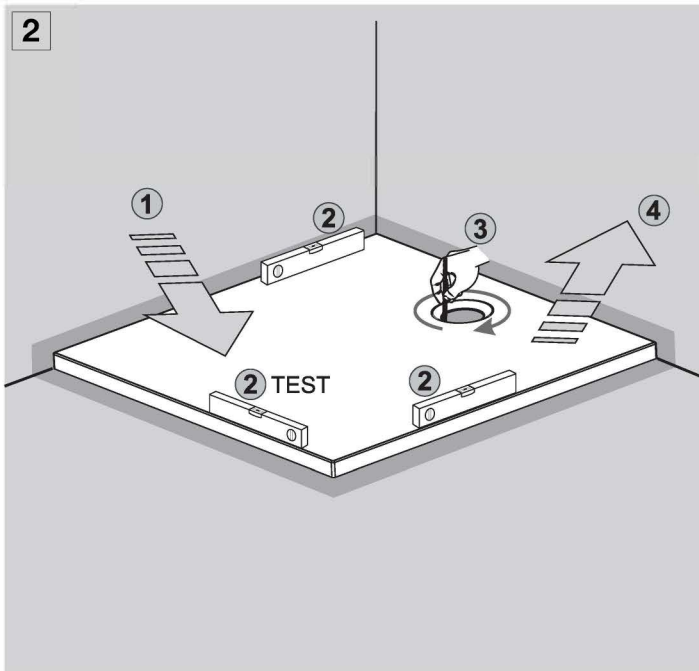

VIGOUR

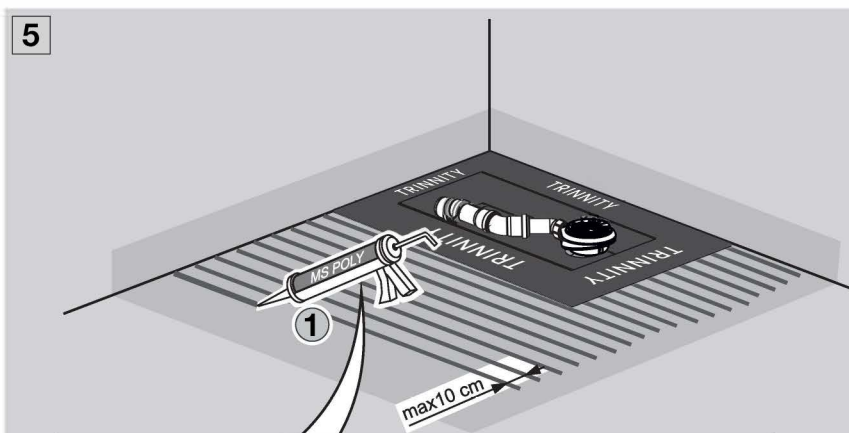

1 HYBRIDKLEBER / HYBRID GLUE (Polyurethan / MS Polymer)
Wir empfehlen auf festen, glatten Untergründen:
We recommend on solid, smooth surfaces:
 PU Montagekleber Conel Care Allround **KBN: CAREALLROUND**

Verwenden Sie keinen Kleber auf Zementbasis!
Do not use cement-based adhesive!



Die Streifen des Hybridklebers müssen auf der gesamten Oberfläche der Duschwanne in ausreichender Dicke aufgetragen werden. Die Kleberstärke muss min. 3-5 mm (gemessen nach Nivellierung der Duschwanne).

The strips of hybrid adhesive must be applied in sufficient thickness below the entire surface of the shower tray. Thickness of the glue must be min. 3-5 mm (measured after leveling the shower tray).

